

GORE BAY
DOWNTOWN
REVITALIZATION





TOWN OF GORE BAY

HARRY SCHLANGE
TOWN MANAGER/CLERK

☎ : +1.705.282.2420

✉ : hschlange@gorebay.ca

WILL SCHICKLUNA
ASSISTANT TO TOWN MANAGER

☎ : +1.705.282.2420

✉ : wshickluna@gorebay.ca

EXP SERVICES INC.

MARK LANGILLE
PROJECT MANAGER

☎ : +1.705.674.9681

✉ : mark.langille@exp.com

ALEXANDER DAWSON—
INSPECTOR/CONTRACT ADMINISTRATOR

☎ : +1.705.348.2607

✉ : alexander.dawson@exp.com

MCA CONTRACTING

JOLENE DOUGLAS
PROJECT MANAGER

☎ : +1.705.885.9440

✉ : qc@mcacontracting.ca

COMMUNICATION

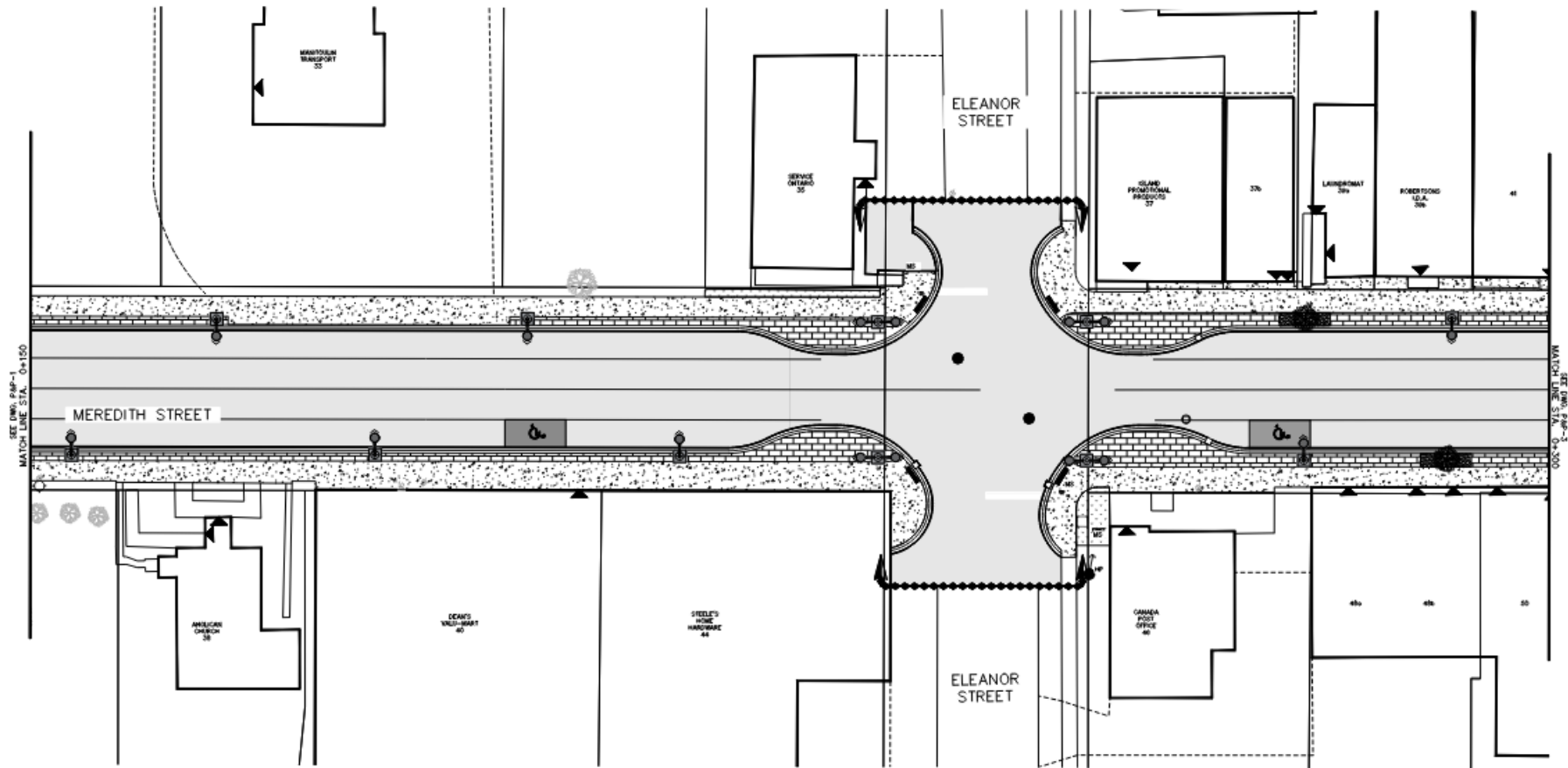

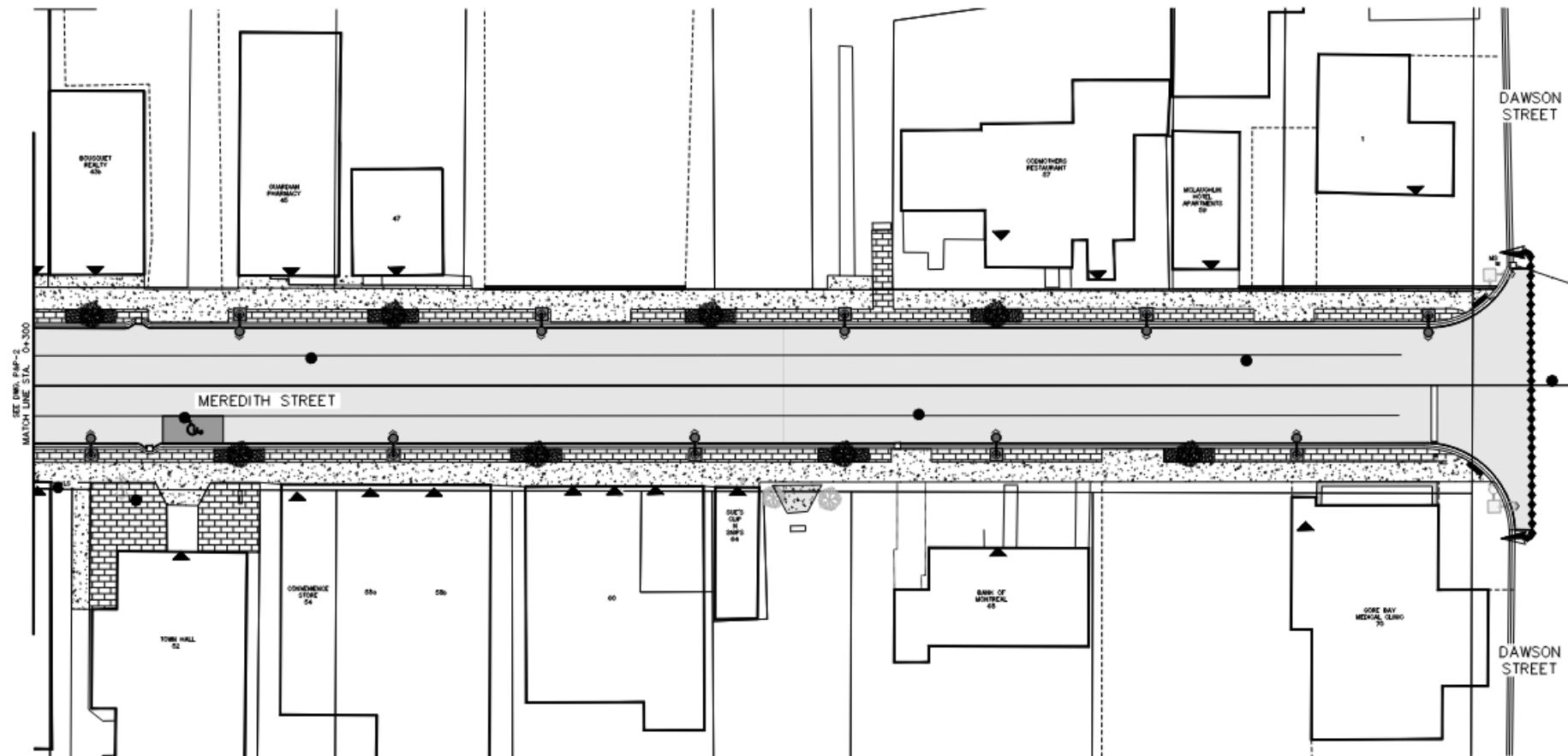

BOULEVARDS

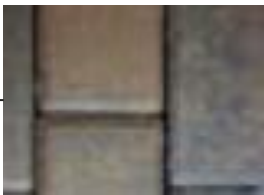

NORDIC STONE

PRIMARY STONE ON THE BOULEVARD



MIDNIGHT CHARCOAL

BORDERED ON EITHER SIDE OF THE BOULEVARD

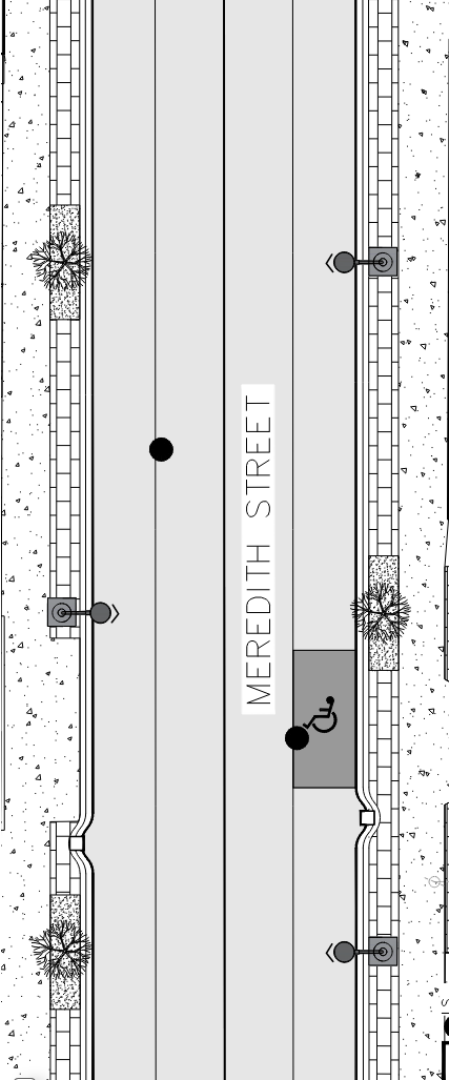
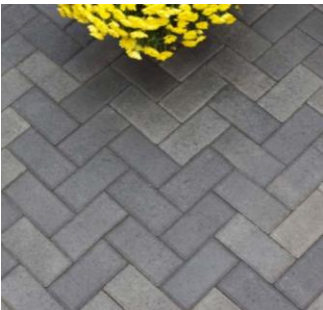
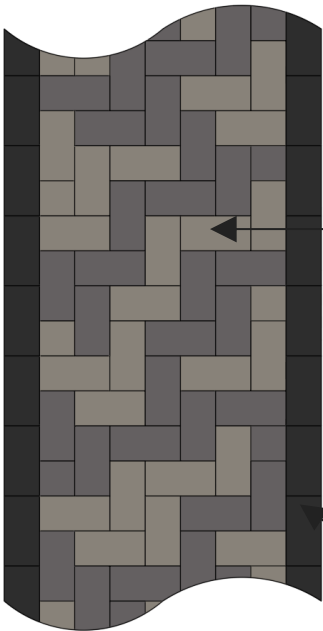



GREENERY

- LOCATED ON THE BOULEVARDS,
BETWEEN TWO LIGHT STANDARDS
- AUTUMN BLAZE MAPLE
- FAST GROWING (3-5 METERS PER YEAR)

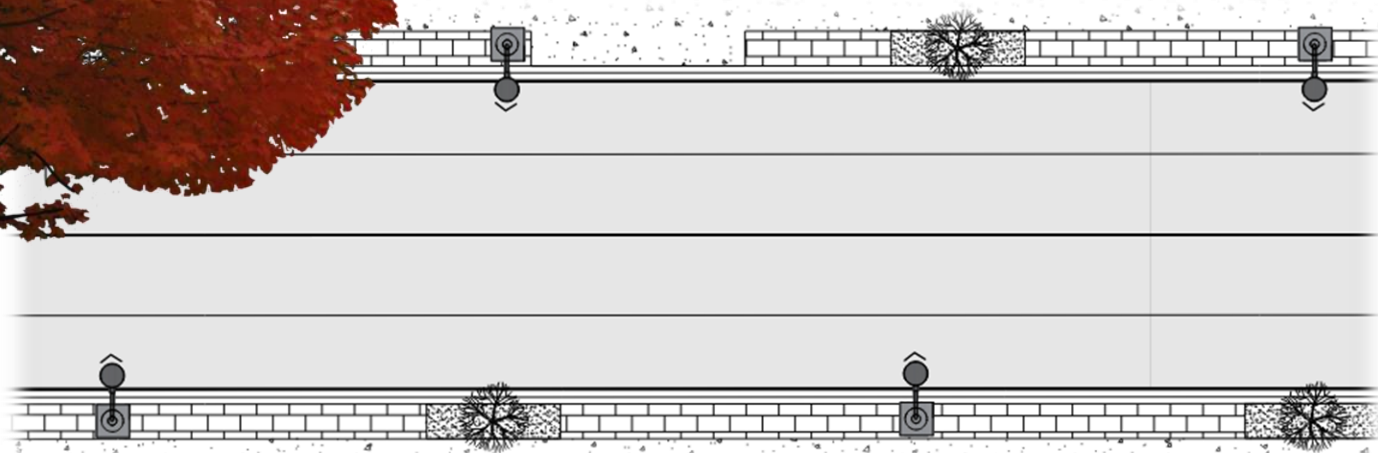

ROOT BARRIERS

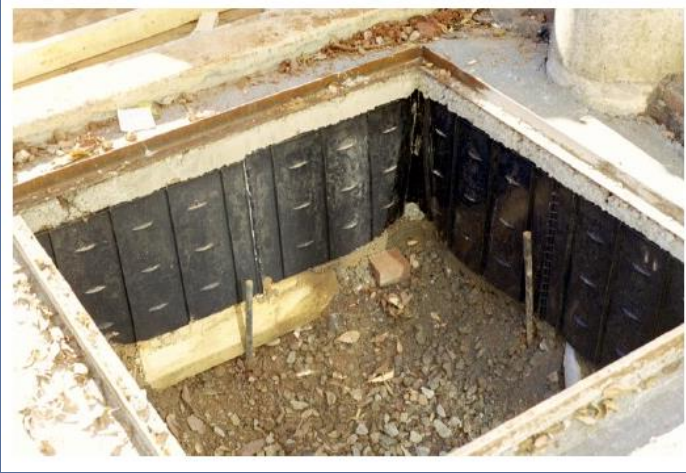

- PROTECTS SURROUNDING LANDSCAPE BY REDIRECTING TREE ROOTS DOWN
- SURROUND APPLICATION, AROUND THE PERIMETER OF THE TREE
- 24" X 24" PANEL SIZES

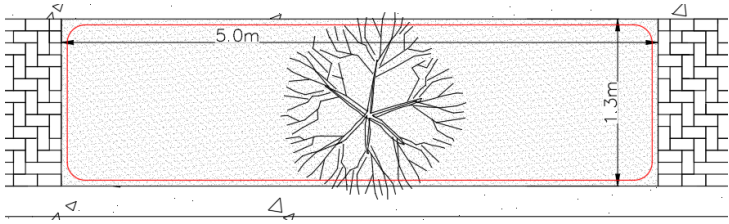

LIGHT STANDARDS AND BANNERS

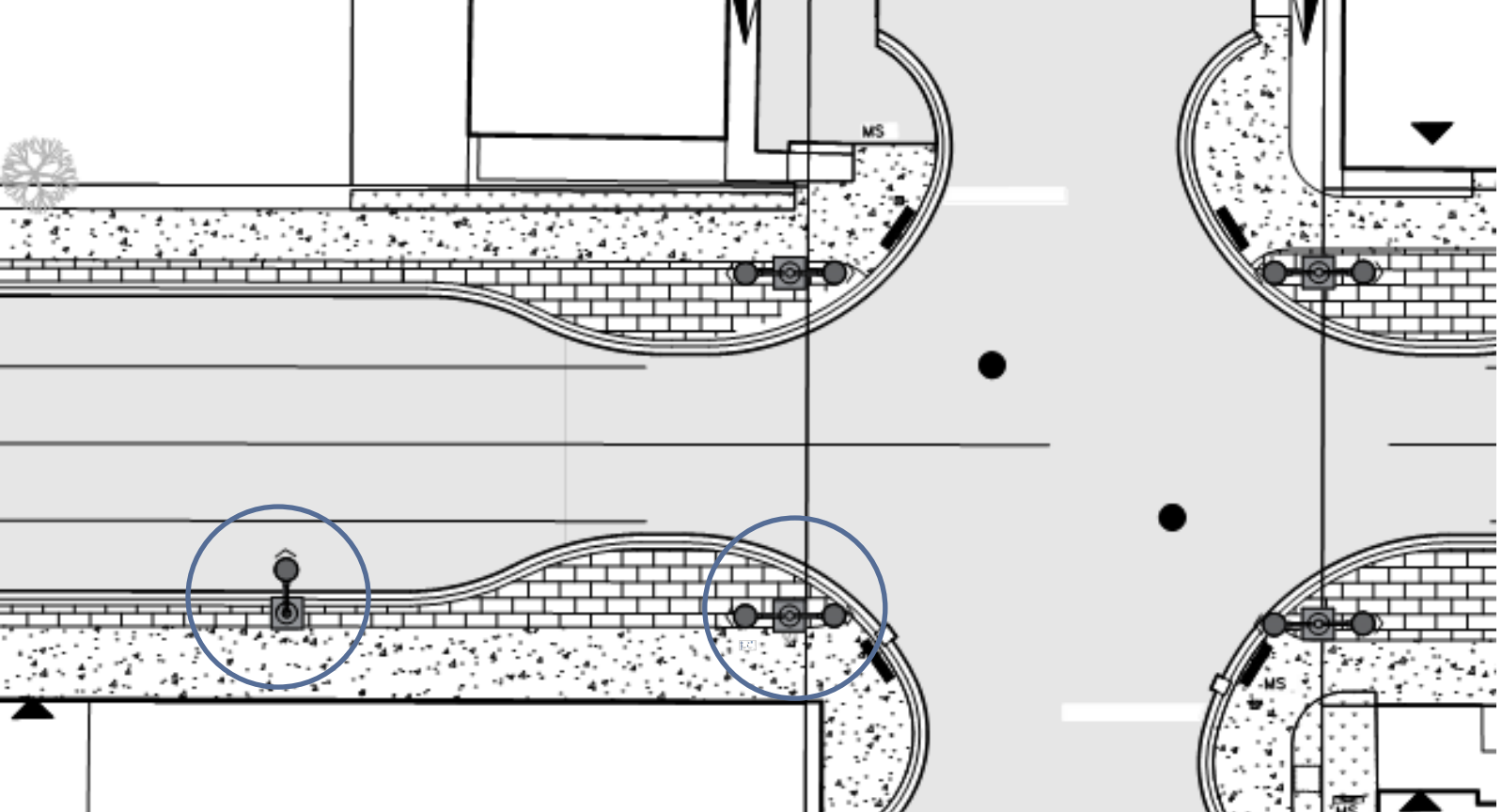

LIGHT STANDARDS AND BANNERS



DOUBLE LIGHT STANDARD WITH BANNER

- LOCATED AT ALL INTERSECTIONS



SINGLE LIGHT STANDARD WITH BANNER

- LOCATED ALONG BOTH SIDES OF THE STREET



RAL 5002 COLOR

- VARIOUS BANNER DESIGNS
- APPROXIMATELY 6.75m TOTAL HEIGHT OF LIGHT STANDARDS

01

CONSTRUCTION SEQUENCING

ESTIMATED TIME REQUIRED: 2-4 DAYS

- REMOVAL OF 0.8m OF ASPHALT BESIDE EACH CURB
- THERE WILL BE NO PARKING ON MEREDITH STREET

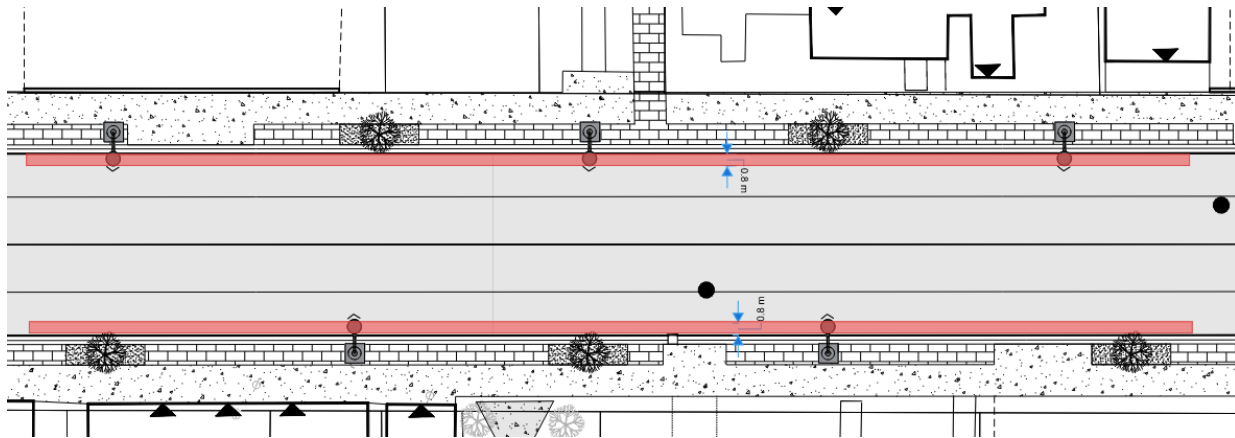

CONSTRUCTION STAGES

WATER SERVICE INSTALLATION, CONCRETE REMOVALS, AND PLACEMENT OF CONCRETE

ESTIMATED TIME REQUIRED: 5-7 WEEKS

- ONE LANE OF TRAFFIC WILL BE OPEN ALLOWING FOR ONE WAY TRAFFIC
- PEDESTRIAN WALKWAYS WILL BE OPEN ON BOTH SIDES OF THE ROAD, SOME DELAYS WILL ARISE ON THE CONSTRUCTION SIDE DURING THE INSTALLATION OF WATER SERVICES, CONCRETE REMOVALS, AND CONCRETE PLACEMENT
- THERE WILL BE NO PARKING ON MEREDITH STREET

CONSTRUCTION STAGES

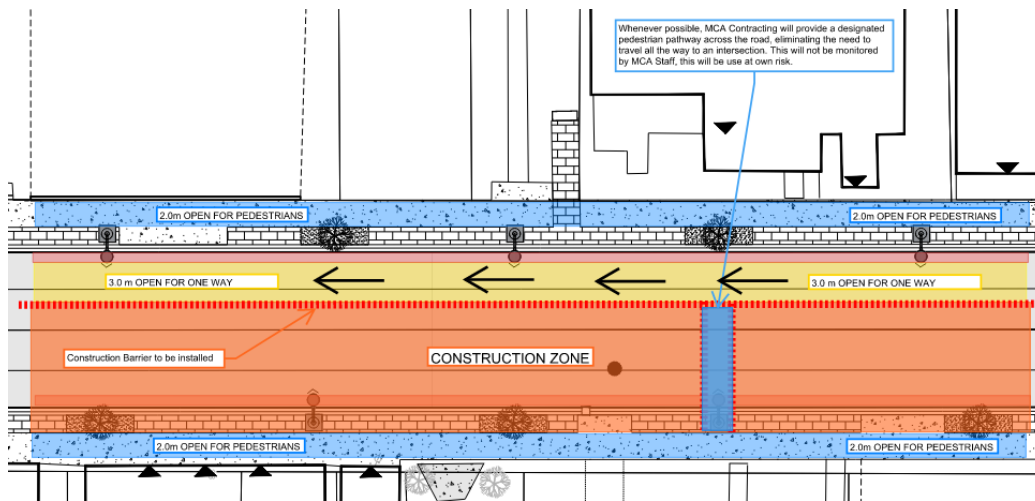

REPETITION OF STAGE 2, ON THE OTHER SIDE OF THE STREET

ESTIMATED TIME REQUIRED: 5-7 WEEKS

- ONE LANE OF TRAFFIC WILL BE OPEN ALLOWING FOR ONE WAY TRAFFIC
- PEDESTRIAN WALKWAYS WILL BE OPEN ON BOTH SIDES OF THE ROAD, SOME DELAYS WILL ARISE ON THE CONSTRUCTION SIDE DURING THE INSTALLATION OF WATER SERVICES, CONCRETE REMOVALS, AND CONCRETE PLACEMENT
- THERE WILL BE NO PARKING ON MEREDITH STREET

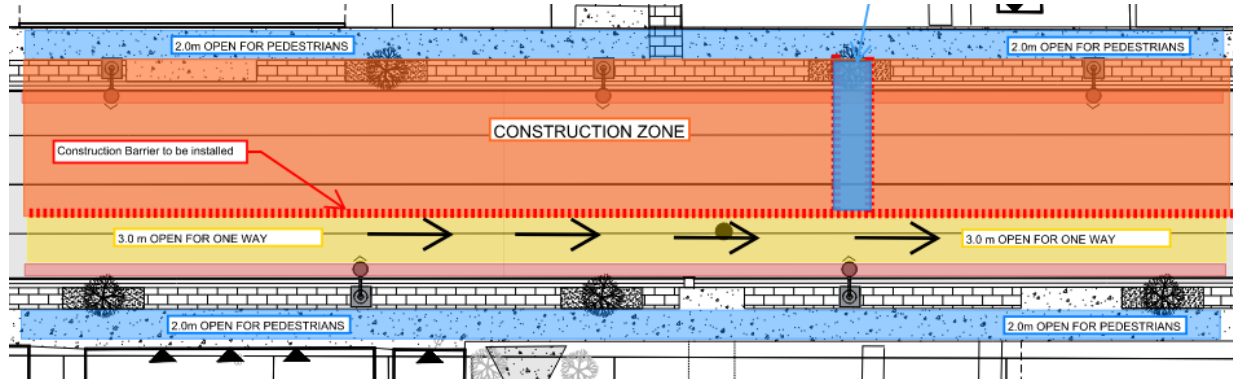

FULL ROAD CLOSURES

- PULVERIZING ASPHALT – 1 DAY
- FINE GRADING THE ROAD PRIOR TO ASPHALT PAVEMENT – 3 DAYS
- PLACING ASPHALT – 2 DAYS
- LINE PAINTING – 1 DAY
- PEDESTRIAN WALKWAYS WILL REMAIN OPEN ON BOTH SIDES OF MEREDITH STREET

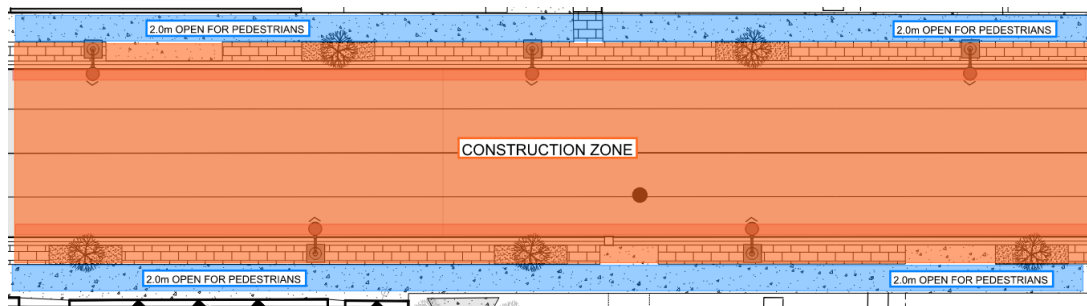



OPEN

**FOR BUSINESS DURING
CONSTRUCTION**

THANK YOU

